

TEMBREAK 2

MOULDED CASE CIRCUIT BREAKERS 16A TO 630

1. Welcome to TemBreak 2
2. Ratings and Specifications
3. Operating Characteristics
4. Co-ordination Characteristics
5. Accessories
6. Installation
7. Dimensions

TEMBREAK 2

MINI MOULDED CASE CIRCUIT BREAKERS 10A TO 100A

8. TemBreak 2 MINI Moulded Case Circuit Breakers

TEMBREAK 2

MOULDED CASE CIRCUIT BREAKERS 630A TO 1600A

9. TemBreak Moulded Case Circuit Breakers

10. Order Codes

• 1P MCCBs	179
• Accessories for 1P MCCBs	180
• 125A Frame MCCBs	181
• Accessories for 125A Frame MCCBs	182
• 250A Frame MCCBs	189
• Accessories for 250A Frame MCCBs	192
• 400A and 630A Frame MCCBs	198
• Accessories for 400A & 630A Frame MCCBs	204
• TemBreak 800A Frame MCCBs	211
• Internal Accessories for TemBreak 800A Frame MCCBs	213
• External Accessories for TemBreak 800A Frame MCCBs	215
• TemBreak 1250A & 1600A Frame MCCBs	220
• Internal Accessories for 1250A & 1600A Frame MCCBs	222
• External Accessories for 1250A & 1600A Frame MCCBs	224
• TemBreak 2 Mini MCCBs	230
• Accessories for Tembreak 2 Mini MCCBs	231
• Switch-Disconnectors, All Frame Sizes	234
• TemTransfer	235

A note on item codes:

13-digit EAN codes are shown in full against applicable items. These correspond to the barcode on the product packaging and facilitate inventory management using barcode scanning.

Only the last 6 digits of the code are required to identify an item from the TemBreak 2 range of products. The preceding 7 digits may be omitted from orders and enquiries.

ORDER CODES

1P MCCBS



Dimensions		
h	(mm)	155
w	(mm)	30
d	(mm)	68

Model	I_n (A)	1P
S125-NF $I_{CU}=25$ kA Thermal Magnetic	16	4547560 254796
	20	4547560 254703
	25	4547560 254710
	32	4547560 254727
	40	4547560 254734
	50	4547560 254741
	63	4547560 254758
	80	4547560 254765
	100	4547560 254772
	125	4547560 254789



Dimensions		
h	(mm)	165
w	(mm)	35
d	(mm)	68

Model	I_n (A)	1P
S160-NF $I_{CU}=25$ kA Thermal Magnetic	16	4547560 326707
	20	4547560 326714
	25	4547560 326721
	32	4547560 326738
	40	4547560 326745
	50	4547560 326752
	63	4547560 326769
	80	4547560 326776
	100	4547560 326783
	125	4547560 326790
	160	4547560 326806

ACCESSORIES FOR 1P MCCBS

Shunt Trips (SHT)

Field Fit Accessory		Code
	AC 100-120V for S160-NF	4547560 001000
	AC 200-240V for S160-NF	4547560 001017
	AC 380-450V for S160-NF	4547560 001024
	DC 24V for S160-NF	4547560 001031
	DC 48V for S160-NF	4547560 001048
	DC 100-120V for S160-NF	4547560 001055
	DC 200-240V for S160-NF	4547560 001062

Extension Bars (FB)

Flat Bars Field Fit Accessory		Code
	1 bar for S125-NF	4547560 010064
	1 bar for S160-NF	4547560 010101

Cable Clamps (FW)

Solderless Terminals Field Fit Accessory		Code
	1 clamp for S125-NF	4547560 080692
	1 clamp for S160-NF	4547560 080760

Terminal Covers For Front Connections (CF)

Field Fit Accessory		Code
	1 cover for S125-NF	4547560 080401
	1 cover for S160-NF	4547560 080449
	Terminal cover lock	4547560 038020

Terminal Covers For Cable Clamps (CS)

Terminal Covers for Solderless Terminal Field Fit Accessory		Code
	1 cover for S125-NF	4547560 080531
	1 cover for S160-NF	4547560 080579
	Terminal cover lock	4547560 038020

Handle Locks (HL)



Field Fit Accessory		Code
For 125AF		211011001
For 250AF		4547560 037016

ORDER CODES

125A FRAME MCCBS



Dimensions		E125	H125
		S125	L125
h (mm)		155	165
w (mm)	3 pole	90	105
	4 pole	120	140
d (mm)		68	103

Model	I _R (A)	3P	4P
E125-NJ I _{cu} = 25 kA Thermal Magnetic	13-20	4547560 254802	4547560 254901
	20-32	4547560 254819	4547560 254918
	32-50	4547560 254826	4547560 254925
	40-63	4547560 254833	4547560 254932
	63-100	4547560 254840	4547560 254949
	79-125	4547560 254857	4547560 254956
S125-NJ I _{cu} = 36kA Thermal Magnetic	13-20	4547560 255007	4547560 255106
	20-32	4547560 255014	4547560 255113
	32-50	4547560 255021	4547560 255120
	40-63	4547560 255038	4547560 255137
	63-100	4547560 255045	4547560 255144
	79-125	4547560 255052	4547560 255151
S125-GJ I _{cu} = 65kA Thermal Magnetic	13-20	4547560 255205	4547560 255304
	20-32	4547560 255212	4547560 255311
	32-50	4547560 255229	4547560 255328
	40-63	4547560 255236	4547560 255335
	63-100	4547560 255243	4547560 255342
	79-125	4547560 255250	4547560 255359
H125-NJ* I _{cu} = 125kA Thermal Magnetic	13-20	4547560 255403	4547560 255502
	20-32	4547560 255410	4547560 255519
	32-50	4547560 255427	4547560 255526
	40-63	4547560 255434	4547560 255533
	63-100	4547560 255441	4547560 255540
	79-125	4547560 255458	4547560 255557
L125-NJ* I _{cu} = 200kA Thermal Magnetic	13-20	4547560 255601	4547560 255700
	20-32	4547560 255618	4547560 255717
	32-50	4547560 255625	4547560 255724
	40-63	4547560 255632	4547560 255731
	63-100	4547560 255649	4547560 255748
	79-125	4547560 255656	4547560 255755

ACCESSORIES FOR 125A FRAME MCCBS

Auxiliary Switches (AX) General Purpose



Field Fit Accessory	Code
Changeover	4547560 000348
Changeover for low currents (mA)	4547560 000324

Auxiliary Switches (AX) Heavy Duty



Field Fit Accessory	Code
Normally open	4547560 000300
Normally closed	4547560 000317

Alarm Switches (AL) General Purpose

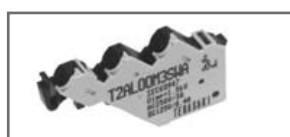

Field Fit Accessory	Code
Changeover	4547560 000744
Changeover for low currents (mA)	4547560 000720

Alarm Switches (AL) Heavy Duty



Field Fit Accessory	Code
Normally open	4547560 000706
Normally closed	4547560 000713

Shunt Trips (SHT)



Field Fit Accessory	Code
AC 100-120V	4547560 000904
AC 200-240V	4547560 000911
AC 380-450V	4547560 000928
DC 24V	4547560 000935
DC 48V	4547560 000942
DC 100-120V	4547560 000959
DC 200-240V	4547560 000966

ORDER CODES

ACCESSORIES FOR 125A FRAME MCCBS

Instantaneous Undervoltage Trips (UVT)



Field Fit Accessory	Code
AC 100-120V	4547560 001208
AC 200-240V	4547560 001215
AC 380-450V	4547560 001222
DC 24V	4547560 001239
DC 100-120V	4547560 001246
DC 200-240V	4547560 001253

Extension Bars (FB)



Flat Bars Field Fit Accessory	Code
3 bars	4547560 010026
4 bars	4547560 010040

Rear Connections (RC)



Flat Bar Studs Field Fit Accessory	Code
3 studs for E and S types	4547560 080111
4 studs for E and S types	4547560 080128
3 studs for H and L types	4547560 080180
4 studs for H and L types	4547560 080197

Fixed Part of Plug-in MCCB (PM)



Plug-in Mount Blocks Field Fit Accessory	Code
3P	4547560 012181
4P	4547560 012266

A plug-in conversion is also required to complete the plug-in MCCB

Plug-in Conversion for MCCB



For Removable Part of Plug-in MCCB Field Fit Accessory	Code
3P for E and S types	4547560 800009
4P for E and S types	4547560 800016
3P for H and L types	4547560 800061
4P for H and L types	4547560 800078

A fixed part is also required to complete the plug-in MCCB

ACCESSORIES FOR 125A FRAME MCCBS

Extension Terminal for Fixed Part of Plug-in MCCB (PF)



Flat Bar for PIB Field Fit Accessory	Code
3 bars	4547560 045813
4 bars	4547560 045820

Control Wiring Terminals for Plug-in MCCBs

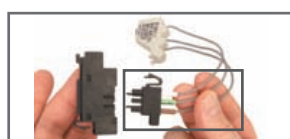

Plug for Removable Part of MCCB, 3 terminals Field Fit Accessory	Code
Plug for auxiliary switches and alarm switches	4547560 800108
Plug for shunt trips and undervoltage trips	4547560 800115

Order one plug for each internal accessory

Control Wiring Terminals for Plug-in MCCBs

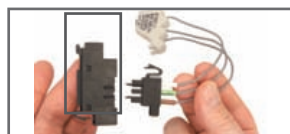

Socket for Fixed Part of MCCB, 3 terminals Field Fit Accessory	Code
Socket	4547560 045004

Order one socket for each electrical accessory

Cable Clamps (FW)

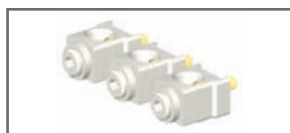

Solderless Terminals Field Fit Accessory	Code
3 clamps for E and S types	4547560 080715
4 clamps for E and S types	4547560 080722
3 clamps for H and L types	4547560 080746
4 clamps for H and L types	4547560 080753

Motor Operation (MC)



Field Fit Accessory	Code
AC 100-110V	4547560 720000
AC 200-220V	4547560 720017
AC 230-240V	4547560 720024
DC 24V	4547560 720031
DC 48V	4547560 720048
DC 100V	4547560 720055

ORDER CODES

ACCESSORIES FOR 125A FRAME MCCBS

Motor Operation (MC) with Automatic Reset



Field Fit Accessory	Code
AC 100-110V	4547560 755309
AC 200-220V	4547560 755316
AC 230-240V	4547560 755323
DC 24V	4547560 755330
DC 48V	4547560 755347
DC 100V	4547560 755354

Motor plus keylock available on request

Door Flanges

Field Fit Accessory	Code
For toggle operation	4547560 044908
For motorised operation	4547560 044915

External Operating Handles (Breaker Mounted Type) (HB)



Field Fit Accessory	Code
Black handle IP3X	4547560 722035
Black handle IP3X with keylock	4547560 722004
Red handle IP3X	4547560 722639
Red handle IP3X with keylock	4547560 722608
Black handle IP5X	4547560 722042
Black handle IP5X with keylock	4547560 722011
Red handle IP5X	4547560 722646
Red handle IP5X with keylock	4547560 722615

ACCESSORIES FOR 125A FRAME MCCBS

External Operating Handles (Panel Mounted Type) (HP)



Field Fit Accessory	Code
Black handle IP54	4547560 750199
Black handle IP54 with keylock	4547560 750038
Red handle IP54	4547560 750830
Red handle IP54 with keylock	4547560 750670
Black Handle IP65	4547560 750236
Black Handle IP65 with keylock	4547560 750076
Red Handle IP65	4547560 750878
Red Handle IP65 with keylock	4547560 750717

Slide Type Mechanical Interlocks (MS)



Field Fit Accessory	Code
E,S type for front / rear connection 125AF 3P	4547560 033513
E,S type for front / rear connection 125AF 4P	4547560 033520
E,S type for plug-in type 125AF 3P	4547560 033544
E,S type for plug-in type 125AF 4P	4547560 033551
H,L type for front / rear connection 125AF 3P	4547560 033575
H,L type for front / rear connection 125AF 4P	4547560 033582
H,L type for plug-in type 125AF 3P	4547560 033681
H,L type for plug-in type 125AF 4P	4547560 033698

Order one part between two MCCBs

Link Type Mechanical Interlocks (ML)



Field Fit Accessory	Code
Right side	4547560 035005
Left side 3P	4547560 035012
Left side 4P	4547560 035029

Order one interlock part for each MCCB

ORDER CODES

ACCESSORIES FOR 125A FRAME MCCBS

Wire Type Mechanical Interlocks (MW)



Field Fit Accessory	Code
Interlock	4547560 036026
1m length interlock cable	4547560 036064
1.5m length interlock cable	4547560 036057

Order one interlock part for each MCCB and one cable between two MCCBs

Handle Locks (HL)



Field Fit Accessory	Code
For 125 / 250AF	4547560 037016

Castell Lock

Field Fit Accessory	Code
Fittings for panel mounted type handle (lock and key not included)	4547560 037054
Fittings for toggle operated MCCB ((lock and key not included)	4547560 037023

Terminal Covers for Front Connection (CF)

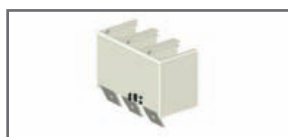

Field Fit Accessory	Code
3P, 1 cover for E and S types	4547560 080425
4P, 1 cover for E and S types	4547560 080432
3P, 1 cover for H and L types	4547560 080654
4P, 1 cover for H and L types	4547560 080661
Earth barrier for 125 3P barrier	4547560 008634
Earth barrier for 125 4P barrier	4547560 008641
Terminal cover lock	4547560 038006

ACCESSORIES FOR 125A FRAME MCCBS

Terminal Covers for Rear Connection and Plug-In (CR)



Field Fit Accessory	Code
3P, 1 cover for E and S types	4547560 080487
4P, 1 cover for E and S types	4547560 080494
4P, 1 cover for H and L types	4547560 080517
3P, 1 cover for H and L types	4547560 080524
Terminal cover lock	4547560 038006

Terminal Covers for Cable Clamps (CS)



Terminal Covers for Solderless Terminal Field Fit Accessory	Code
3P, 1 cover for E and S types	4547560 080555
4P, 1 cover for E and S types	4547560 080562
4P, 1 cover for H and L types	4547560 080586
3P, 1 cover for H and L types	4547560 080593
Terminal cover lock	4547560 038006

Interpole Barriers (BA)

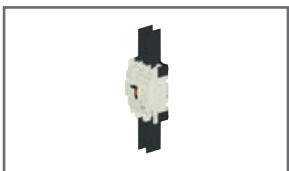

Field Fit Accessory	Code
For E and S types	4547560 043062
For H and L types	4547560 043260

Interpole barriers are supplied as standard: 2 pieces per 3P MCCB, 3 pieces per 4P MCCB.
For additional barriers please order individually

Lead Terminal Block



Field Fit Accessory	Code
Left side	4547560 044526
Right side	4547560 044533

DIN Rail Adapter

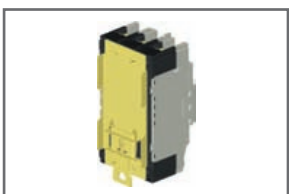

Field Fit Accessory	Code
DIN rail adapter for 125AF	4547560 045103

ORDER CODES

250A FRAME MCCBS



Dimensions		H160	
		S160	L160
		E250	H250
		S250	L250
h (mm)		165	165
w (mm)	3 pole	105	105
	4 pole	140	140
d (mm)		68	103

Model	I_R (A)	3P	4P
S160-NJ $I_{cu} = 36$ kA * $I_{cu} = 30$ kA Thermal Magnetic	13-20*	4547560 326837	4547560 326905
	20-32*	4547560 326844	4547560 326912
	32-50	4547560 326851	4547560 326929
	40-63	4547560 326868	4547560 326936
	63-100	4547560 326875	4547560 326943
	79-125	4547560 326882	4547560 326950
	101-160	4547560 326899	4547560 326967
S160-GJ $I_{cu} = 65$ kA Thermal Magnetic	32-50	4547560 327025	4547560 327124
	40-63	4547560 327032	4547560 327131
	63-100	4547560 327049	4547560 327148
	79-125	4547560 327056	4547560 327155
	101-160	4547560 327063	4547560 327162
H160-NJ $I_{cu} = 125$ kA Thermal Magnetic	101-160	4547560 318474	4547560 318573
L160-NJ $I_{cu} = 200$ kA Thermal Magnetic	101-160	4547560 318672	4547560 318771

250A FRAME MCCBS

Model	I_R (A)	3P	4P
E250-NJ $I_{cu} = 25\text{kA}$ Thermal Magnetic	13-20	4547560 327209	4547560 327308
	20-32	4547560 327216	4547560 327315
	32-50	4547560 327223	4547560 327322
	40-63	4547560 327230	4547560 327339
	63-100	4547560 327247	4547560 327346
	79-125	4547560 327254	4547560 327353
	101-160	4547560 327261	4547560 327360
	126-200	4547560 327278	4547560 327377
	158-250	4547560 327285	4547560 327384
S250-NJ $I_{cu} = 36\text{ kA}$ Thermal Magnetic	101-160	4547560 312021	4547560 312120
	126-200	4547560 312052	4547560 312151
	158-250	4547560 312038	4547560 312137
S250-GJ $I_{cu} = 65\text{ kA}$ Thermal Magnetic	101-160	4547560 312229	4547560 312328
	126-200	4547560 312250	4547560 312359
	158-250	4547560 312236	4547560 312335
H250-NJ $I_{cu} = 125\text{ kA}$ Thermal Magnetic	101-160	4547560 312427	4547560 312526
	158-250	4547560 312434	4547560 312533
L250-NJ $I_{cu} = 200\text{ kA}$ Thermal Magnetic	101-160	4547560 312625	4547560 312724
	158-250	4547560 312632	4547560 312731

ORDER CODES

250A FRAME MCCBS

Model		I_R (A)	3P	4P
S250-PE $I_{cu} = 70$ kA Electronic <i>Electronic Protection Codes: A - LSI; P - Preferential Trip Alarm; G - Ground Fault; N - Neutral Protection</i>	A	16-40	4547560 327704	4547560 327728
	AN	16-40		4547560 327742
	AP	16-40	4547560 327711	4547560 327735
	APN	16-40		4547560 327759
	A	50-125	4547560 327803	4547560 327827
	AN	50-125		4547560 327841
	AP	50-125	4547560 327810	4547560 327834
	APN	50-125		4547560 327858
	A	64-160	4547560 327902	4547560 327926
	AN	64-160		4547560 327940
	AP	64-160	4547560 327919	4547560 327933
	APN	64-160		4547560 327957
	A	100-250	4547560 319006	4547560 319013
	AN	100-250		4547560 319044
	AP	100-250	4547560 319020	4547560 319037
	APN	100-250		4547560 319051
H250-NE $I_{cu} = 125$ kA Electronic <i>Electronic Protection Codes: A - LSI; P - Preferential Trip Alarm; G - Ground Fault; N - Neutral Protection</i>	A	16-40	4547560 328008	4547560 328022
	AN	16-40		4547560 328046
	AP	16-40	4547560 328015	4547560 328039
	APN	16-40		4547560 328053
	A	50-125	4547560 328107	4547560 328121
	AN	50-125		4547560 328145
	AP	50-125	4547560 328144	4547560 328138
	APN	50-125		4547560 328152
	A	64-160	4547560 328206	4547560 328220
	AN	64-160		4547560 328244
	AP	64-160	4547560 328213	4547560 328237
	APN	64-160		4547560 328251
	A	100-250	4547560 319105	4547560 319112
	AN	100-250		4547560 319143
	AP	100-250	4547560 319129	4547560 319136
	APN	100-250		4547560 319150

ACCESSORIES FOR 250A FRAME MCCBS

Auxiliary Switches (AX) General Purpose



Field Fit Accessory	Code
Changeover	4547560 000348
Changeover for low currents (mA)	4547560 000324

Auxiliary Switches (AX) Heavy Duty



Field Fit Accessory	Code
Normally open	4547560 000300
Normally closed	4547560 000317

Alarm Switches (AL) General Purpose



Field Fit Accessory	Code
Changeover	4547560 000744
Changeover for low currents (mA)	4547560 000720

Alarm Switches (AL) Heavy Duty



Field Fit Accessory	Code
Normally open	4547560 000706
Normally closed	4547560 000713

Shunt Trips (SHT)



Field Fit Accessory	Code
AC 100-120V	4547560 000904
AC 200-240V	4547560 000911
AC 380-450V	4547560 000928
DC 24V	4547560 000935
DC 48V	4547560 000942
DC 100-120V	4547560 000959
DC 200-240V	4547560 000966

ORDER CODES

ACCESSORIES FOR 250A FRAME MCCBS

Instantaneous Undervoltage Trips (UVT)



Field Fit Accessory	Code
AC 100-120V	4547560 001208
AC 200-240V	4547560 001215
AC 380-450V	4547560 001222
DC 24V	4547560 001239
DC 100-120V	4547560 001246
DC 200-240V	4547560 001253

Extension Bars (FB)

Flat Bars Field Fit Accessory	Code
3 Bars	4547560 010149
4 Bars	4547560 010163

Rear Connections (RC)



Flat Bar Studs Field Fit Accessory	Code
3 studs for E and S types	4547560 080159
4 studs for E and S types	4547560 080166
3 studs for H and L types	4547560 080180
4 studs for H and L types	4547560 080197

Fixed Part of Plug-in MCCB (PM)



Plug-in Mount Blocks Field Fit Accessory	Code
3P	4547560 012365
4P	4547560 012464

A plug-in conversion is also required to complete the plug-in MCCB

Plug-in Conversion for MCCB



For Removable Part of Plug-in MCCB Field Fit Accessory	Code
3P for E and S types	4547560 800023
4P for E and S types	4547560 800030
4P for H and L types	4547560 800061
3P for H and L types	4547560 800078

A fixed part is also required to complete the plug-in MCCB

ACCESSORIES FOR 250A FRAME MCCBS

Extension Terminal for Fixed Part of Plug-in MCCB (PF)



Flat Bar for PIB Field Fit Accessory	Code
3 Bars	4547560 045837
4 Bars	4547560 045844

Control Wiring Terminals for Plug-in MCCBs

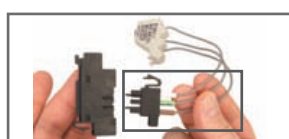

Plug for Removable Part of MCCB, 3 terminals Field Fit Accessory	Code
Plug for auxiliary switches and alarm switches	4547560 800108
Plug for shunt trips and undervoltage trips	4547560 800115

Order one plug for each internal accessory

Control Wiring Terminals for Plug-in MCCBs

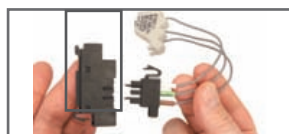

Socket for Fixed Part of MCCB, 3 terminal Field Fit Accessory	Code
Socket	4547560 045004

Order one socket for each internal accessory

Cable Clamps (FW)

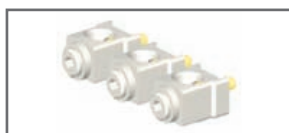

Solderless Terminals Field Fit Accessory	Code
3 clamps	4547560 080784
4 clamps	4547560 080791

Motor Operation (MC)



Field Fit Accessory	Code
100V to 110V AC	4547560 720109
200V to 220V AC	4547560 720116
230V to 240V AC	4547560 720123
24V DC	4547560 720130
48V DC	4547560 720147
100V DC	4547560 720154

ORDER CODES

ACCESSORIES FOR 250A FRAME MCCBS

Motor Operation (MC) with Automatic Reset



Field Fit Accessory	Code
100V to 110V AC	4547560 755408
200V to 220V AC	4547560 755415
230V to 240V AC	4547560 755422
24V DC	4547560 755439
48V DC	4547560 755446
100V DC	4547560 755453

Motor plus keylock available on request

Door Flanges

Field Fit Accessory	Code
For toggle operation	4547560 044908
For motorised operation	4547560 044915

External Operating Handles (Breaker Mounted Type) (HB)



Field Fit Accessory	Code
Black handle IP3X	4547560 723230
Black handle IP3X with keylock	4547560 723209
Red handle IP3X	4547560 723834
Red handle IP3X with keylock	4547560 723803
Black handle IP5X	4547560 723247
Black handle IP5X with keylock	4547560 723216
Red handle IP5X	4547560 723841
Red handle IP5X with keylock	4547560 723810

External Operating Handles (Panel Mounted Type) (HP)



Field Fit Accessory	Code
Black handle IP54	4547560 752193
Black handle IP54 with keylock	4547560 752032
Red handle IP54	4547560 752834
Red handle IP54 with keylock	4547560 752674
Black Handle IP65	4547560 752230
Black Handle IP65 with keylock	4547560 752070
Red Handle IP65	4547560 752872
Red Handle IP65 with keylock	4547560 752711

ACCESSORIES FOR 250A FRAME MCCBS

Slide Type Mechanical Interlocks (MS)



Field Fit Accessory	Code
E,S type for front, rear connection 250AF 3P	4547560 033605
E,S type for front, rear connection type 250AF 4P	4547560 033612
E,S type for plug-in type 250AF 3P	4547560 033629
E,S type for plug-in type 250AF 4P	4547560 033636
H,L type for front, rear connection type 250AF 3P	4547560 033643
H,L type for front, rear connection type 250AF 4P	4547560 033650
H,L type for plug-in type 250AF 3P	4547560 033667
H,L type for plug-in type 250AF 4P	4547560 033674

Order one part between two MCCBs

Link Type Mechanical Interlocks (ML)



Field Fit Accessory	Code
Right side	4547560 035104
Left side 3P	4547560 035111
Left side 4P	4547560 035128

Order one interlock part for each MCCB

Wire Type Mechanical Interlocks (MW)



Field Fit Accessory	Code
Interlock	4547560 036125
1m length interlock cable	4547560 036064
1.5m length interlock cable	4547560 036057

Order one interlock part for each MCCB and one cable between two MCCBs

Handle Locks (HL)



Field Fit Accessory	Code
For 125 / 250AF	4547560 037016

Castell Lock

Field Fit Accessory	Code
Fittings for panel mounted type handle (lock and key not included)	4547560 037054
Fittings for toggle operated MCCB ((lock and key not included)	4547560 037047

ORDER CODES

ACCESSORIES FOR 250A FRAME MCCBS

Terminal Covers for Front Connection (CF)



Field Fit Accessory	Code
3P, 1 cover for E and S types	4547560 080456
4P, 1 cover for E and S types	4547560 080463
3P, 1 cover for H and L types	4547560 080654
4P, 1 cover for H and L types	4547560 080661
Earth barrier for 250AF 3P barrier	4547560 008658
Earth barrier for 250AF 4P barrier	4547560 008665
Terminal cover lock	4547560 038006

Terminal Covers for Rear Connection and Plug-In (CR)



Field Fit Accessory	Code
3P, 1 cover	4547560 080517
4P, 1 cover	4547560 080524
Terminal cover lock	4547560 038006

Terminal Covers for Cable Clamps (CS)



Terminal Covers for Solderless Terminal Field Fit Accessory	Code
3P, 1 cover	4547560 080586
4P, 1 cover	4547560 080593
Terminal cover lock	4547560 038006

Interpole Barriers (BA)



Field Fit Accessory	Code
For E and S types	4547560 043161
For H and L types	4547560 043260

Interpole barriers are supplied as standard: 2 pieces per 3P MCCB, 3 pieces per 4P MCCB. For additional barriers please order individually

Lead Terminal Block



Field Fit Accessory	Code
Left side	4547560 044526
Right side	4547560 044533

400A & 630A FRAME MCCBS

400A Frame MCCBs with Front Connections



Dimensions		E400	H400
		S400	L400
h (mm)		260	260
w (mm)	3 pole	140	140
	4 pole	185	185
d (mm)		103	140

Model	I_R (A)		3P	4P
E400-NJ $I_{cu} = 25\text{kA}$ Thermal Magnetic	158-250		4547560 361326	4547560 361425
	252-400		4547560 361333	4547560 361432
S400-CJ $I_{cu} = 36\text{ kA}$ Thermal Magnetic	158-250		4547560 368325	4547560 368523
	252-400		4547560 368332	4547560 368530
S400-NJ $I_{cu} = 50\text{ kA}$ Thermal Magnetic	158-250		4547560 361524	4547560 361623
	252-400		4547560 361531	4547560 361630
S400-NE $I_{cu} = 50\text{ kA}$ Electronic <small>Electronic Protection Codes: A - Standard relay with LSI characteristic; P - Preferential Trip Alarm; G - Ground Fault; N - Neutral Protection</small>	A	100-250	4547560 374005	4547560 374067
	AN	100-250		4547560 374081
	AP	100-250	4547560 374012	4547560 374074
	APN	100-250		4547560 374098
	A	160-400	4547560 374029	4547560 374104
	AG	160-400	4547560 374043*	
	AN	160-400		4547560 374128
	AP	160-400	4547560 374036	4547560 374111
	AGN	160-400		4547560 374142
	APG	160-400	4547560 374050*	
	APN	160-400		4547560 374135
	APGN	160-400		4547560 374159
S400-GJ $I_{cu} = 70\text{ kA}$ Thermal Magnetic	158-250		4547560 361722	4547560 361821
	252-400		4547560 361739	4547560 361838

*An external neutral CT must be ordered. Refer to External Accessories.

ORDER CODES

400A & 630A FRAME MCCBS

Model		I _R (A)	3P	4P
S400-GE <i>I_{cu} = 70 kA</i> Electronic <i>Electronic Protection Codes: A - Standard relay with LSI characteristic; P - Preferential Trip Alarm; G - Ground Fault; N - Neutral Protection</i>	A	100-250	4547560 364808	4547560 364822
	AN	100-250		4547560 372513
	AP	100-250	4547560 364846	4547560 372506
	APN	100-250		4547560 372520
	A	160-400	4547560 364815	4547560 364839
	AG	160-400	4547560 364884*	
	AN	160-400		4547560 372568
	AP	160-400	4547560 364877	4547560 372551
	AGN	160-400		4547560 372582
	APG	160-400	4547560 364891*	
	APN	160-400		4547560 372575
	APGN	160-400		4547560 372599
H400-NJ <i>I_{cu} = 125 kA</i> Thermal Magnetic		158-250	4547560 361920	4547560 362026
		252-400	4547560 361937	4547560 362033
H400-NE <i>I_{cu} = 125 kA</i> Electronic <i>Electronic Protection Codes: A - Standard relay with LSI characteristic; P - Preferential Trip Alarm; G - Ground Fault; N - Neutral Protection</i>	A	100-250	4547560 364907	4547560 364921
	AN	100-250		4547560 372810
	AP	100-250	4547560 364945	4547560 372803
	APN	100-250		4547560 372827
	A	160-400	4547560 364914	4547560 364938
	AG	160-400	4547560 364983*	
	AN	160-400		4547560 372865
	AP	160-400	4547560 364976	4547560 372858
	AGN	160-400		4547560 372889
	APG	160-400	4547560 364990*	
	APN	160-400		4547560 372872
	APGN	160-400		4547560 372896
L400-NJ <i>I_{cu} = 200 kA</i> Thermal Magnetic		158-250	4547560 362125	4547560 362224
		252-400	4547560 362132	4547560 362231
L400-NE <i>I_{cu} = 200 kA</i> Electronic	A	100-250	4547560 365003	4547560 365027
	AN	100-250		4547560 372919
	AP	100-250	4547560 365041	4547560 372902
	APN	100-250		4547560 372926
	A	160-400	4547560 365010	4547560 365034
	AG	160-400	4547560 365089*	
	AN	160-400		4547560 372964
	AP	160-400	4547560 365072	4547560 372957
	AGN	160-400		4547560 372988
	APG	160-400	4547560 365096*	
	APN	160-400		4547560 372971
	APGN	160-400		4547560 372995

*An external neutral CT must be ordered. Refer to External Accessories.

400A & 630A FRAME MCCBS

400A Frame MCCBs with Rear Connections Fitted



Model	I _R (A)		3P	4P
H400-NJ I _{cu} = 125kA Thermal Magnetic	158-250		4547560 361968	4547560 362064
	252-400		4547560 361975	4547560 362071
H400-NE I _{cu} = 125kA Electronic <i>Electronic Protection Codes: A - Standard relay with LSI characteristic; P - Preferential Trip Alarm; G - Ground Fault; N - Neutral Protection</i>	A	100-250	4547560 373008	4547560 373206
	AN	100-250		4547560 373220
	AP	100-250	4547560 373015	4547560 373213
	APN	100-250		4547560 373237
	A	160-400	4547560 373107	4547560 373305
	AG	160-400	4547560 373121*	
	AN	160-400		4547560 373329
	AP	160-400	4547560 373114	4547560 373312
	AGN	160-400		4547560 373343
	APG	160-400	4547560 373138*	
	APN	160-400		4547560 373336
	APGN	160-400		4547560 373350
L400-NJ I _{cu} = 200 kA Thermal Magnetic	158-250		4547560 362163	4547560 362262
	252-400		4547560 362170	4547560 362279
L400-NE I _{cu} = 200 kA Electronic <i>Electronic Protection Codes: A - Standard relay with LSI characteristic; P - Preferential Trip Alarm; G - Ground Fault; N - Neutral Protection</i>	A	100-250	4547560 373503	4547560 373701
	AN	160-250		4547560 373725
	AP	100-250	4547560 373510	4547560 373718
	APN	100-250		4547560 373732
	A	160-400	4547560 373602	4547560 373800
	AG	160-400	4547560 373626*	
	AN	160-400		4547560 373824
	AP	160-400	4547560 373619	4547560 373817
	AGN	160-400		4547560 373848
	APG	160-400	4547560 373633*	
	APN	160-400		4547560 373831
	APGN	160-400		4547560 373855

*An external neutral CT must be ordered. Refer to External Accessories.

ORDER CODES

400A & 630A FRAME MCCBS

400A Frame MCCBs with Plug-in Connections Fitted*

*Plug-in base and auxiliary connectors must be ordered separately

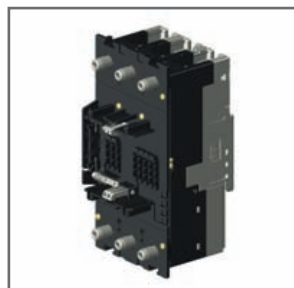

Model	I_R (A)		3P	4P
H400-NJ $I_{cu} = 125kA$ Thermal Magnetic	158-250		4547560 367328	4547560 367427
	252-400		4547560 367335	4547560 367434
H400-NE $I_{cu} = 125kA$ Electronic Electronic Protection Codes: A - Standard relay with LSI characteristic; P - Preferential Trip Alarm; G - Ground Fault; N - Neutral Protection	A	100-250	4547560 373022	4547560 373244
	AN	100-250		4547560 373268
	AP	100-250	4547560 373039	4547560 373251
	APN	100-250		4547560 373275
	A	160-400	4547560 373145	4547560 373367
	AG	160-400	4547560 373169*	
	AN	160-400		4547560 373381
	AP	160-400	4547560 373152	4547560 373374
	AGN	160-400		4547560 373404
	APG	160-400	4547560 373176*	
	APN	160-400		4547560 373398
	APGN	160-400		4547560 373411
L400-NJ $I_{cu} = 200 kA$ Thermal Magnetic	158-250		4547560 367526	4547560 367625
	252-400		4547560 367533	4547560 367632
L400-NE $I_{cu} = 200 kA$ Electronic Electronic Protection Codes: A - Standard relay with LSI characteristic; P - Preferential Trip Alarm; G - Ground Fault; N - Neutral Protection	A	100-250	4547560 373527	4547560 373749
	AN	100-250		4547560 373763
	AP	100-250	4547560 373534	4547560 373756
	APN	100-250		4547560 373770
	A	160-400	4547560 373640	4547560 373862
	AG	160-400	4547560 373664*	
	AN	160-400		4547560 373886
	AP	160-400	4547560 373657	4547560 373879
	AGN	160-400		4547560 373909
	APG	160-400	4547560 373671*	
	APN	160-400		4547560 373893
	APGN	160-400		4547560 373916

*An external neutral CT must be ordered. Refer to External Accessories.

400A & 630A FRAME MCCBS

400A Frame MCCBs with Cable Clamps Fitted

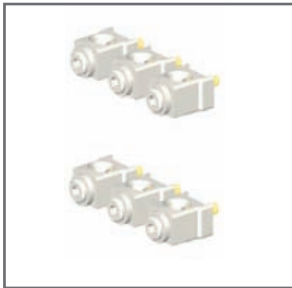

Model	I_R (A)		3P	4P
H400-NJ $I_{cu} = 125kA$ Thermal Magnetic	158-250		4547560 367366	4547560 367465
	252-400		4547560 367373	4547560 367472
H400-NE $I_{cu} = 125kA$ Electronic <i>Electronic Protection Codes: A - Standard relay with LSI characteristic; P - Preferential Trip Alarm; G - Ground Fault; N - Neutral Protection</i>	A	100-250	4547560 373046	4547560 373282
	AN	100-250		4547560 373084
	AP	100-250	4547560 373053	4547560 373299
	APN	100-250		4547560 373091
	A	160-400	4547560 373183	4547560 373428
	AG	160-400	4547560 373060*	
	AN	160-400		4547560 373442
	AP	160-400	4547560 373190	4547560 373435
	AGN	160-400		4547560 373466
	APG	160-400	4547560 373077*	
	APN	160-400		4547560 373459
	APGN	160-400		4547560 373473
L400-NJ $I_{cu} = 200 kA$ Thermal Magnetic	158-250		4547560 367564	4547560 367663
	252-400		4547560 367571	4547560 367670
L400-NE $I_{cu} = 200 kA$ Electronic <i>Electronic Protection Codes: A - Standard relay with LSI characteristic; P - Preferential Trip Alarm; G - Ground Fault; N - Neutral Protection</i>	A	100-250	4547560 373541	4547560 373787
	AN	100-250		4547560 373565
	AP	100-250	4547560 373558	4547560 373794
	APN	100-250		4547560 373572
	A	160-400	4547560 373688	4547560 373923
	AG	160-400	4547560 373480*	
	AN	160-400		4547560 373947
	AP	160-400	4547560 373695	4547560 373930
	AGN	160-400		4547560 373961
	APG	160-400	4547560 373497*	
	APN	160-400		4547560 373954
	APGN	160-400		4547560 373978

*An external neutral CT must be ordered. Refer to External Accessories.

ORDER CODES

400A & 630A FRAME MCCBS

630A Frame MCCBs with Front Connections



Dimensions		E630
		S630
h (mm)		260
w (mm)	3 pole	140
	4 pole	185
d (mm)		103

Model	I_R (A)		3P	4P
E630-NE $I_{cu} = 36$ kA Electronic <small>Electronic Protection Codes: A - Standard relay with LSI characteristic; P - Preferential Trip Alarm; G - Ground Fault; N - Neutral Protection</small>	A	252-630	4547560 365102	4547560 365119
	AG	252-630	4547560 365133*	
	AN	252-630		4547560 365164
	AP	252-630	4547560 365126	4547560 365157
	AGN	252-630		4547560 365188
	APG	252-630	4547560 365140*	
	APN	252-630		4547560 365171
	APGN	252-630		4547560 365195
S630-CE $I_{cu} = 50$ kA Electronic <small>Electronic Protection Codes: A - Standard relay with LSI characteristic; P - Preferential Trip Alarm; G - Ground Fault; N - Neutral Protection</small>	A	252-630	4547560 365201	4547560 365218
	AG	252-630	4547560 365232*	
	AN	252-630		4547560 365263
	AP	252-630	4547560 365225	4547560 365256
	AGN	252-630		4547560 365287
	APG	252-630	4547560 365249*	
	APN	252-630		4547560 365270
	APGN	252-630		4547560 365294
S630-GE $I_{cu} = 70$ kA Electronic <small>Electronic Protection Codes: A - Standard relay with LSI characteristic; P - Preferential Trip Alarm; G - Ground Fault; N - Neutral Protection</small>	A	252-630	4547560 365300	4547560 365317
	AG	252-630	4547560 365331*	
	AN	252-630		4547560 365362
	AP	252-630	4547560 365324	4547560 365355
	AGN	252-630		4547560 365386
	APG	252-630	4547560 365348*	
	APN	252-630		4547560 365379
	APGN	252-630		4547560 365393

*An external neutral CT must be ordered. Refer to External Accessories.

ACCESSORIES FOR 400A & 630A FRAME MCCBS

Auxiliary Switches (AX) *General Purpose*



Field Fit Accessory	Code
Changeover	4547560 000348
Changeover for low currents (mA)	4547560 000324

Auxiliary Switches (AX) *Heavy Duty*



Field Fit Accessory	Code
Normally open	4547560 000300
Normally closed	4547560 000317

Alarm Switches (AL) *General Purpose*



Field Fit Accessory	Code
Changeover	4547560 000744
Changeover for low currents (mA)	4547560 000720

Alarm Switches (AL) *Heavy Duty*



Field Fit Accessory	Code
Normally open	4547560 000706
Normally closed	4547560 000713

Shunt Trips (SHT)



Field Fit Accessory	Code
AC 100-120V	4547560 000904
AC 200-240V	4547560 000911
AC 380-450V	4547560 000928
DC 24V	4547560 000935
DC 48V	4547560 000942
DC 100-120V	4547560 000959
DC 200-240V	4547560 000966

ORDER CODES

ACCESSORIES FOR 400A & 630A FRAME MCCBS

Instantaneous Undervoltage Trips (UVT)



Field Fit Accessory	Code
AC 100-120V	4547560 001208
AC 200-240V	4547560 001215
AC 380-450V	4547560 001222
DC 24V	4547560 001239
DC 100-120V	4547560 001246
DC 200-240V	4547560 001253

Extension Bars (FB)

Flat Bars Field Fit Accessory	Code
3 bars, 400A	4547560 010224
4 bars, 400A	4547560 010248
3 bars, 630A	4547560 010286
4 bars, 630A	4547560 010293

Rear Connections (RC)



Flat Bars Field Fit Accessory	Code
3 studs, 400A	4547560 080210
4 studs, 400A	4547560 080227
3 studs, 630A	4547560 080265
4 studs, 630A	4547560 080272

Rear connections for H400 and L400 models are factory fitted. Item numbers for MCCBs complete with rear connections can be found under "400A Frame MCCBs with Rear Connections Fitted"

Fixed Part of Plug-in MCCB (PM)



Plug-in Mount Blocks Field Fit Accessory	Code
3P	4547560 012563
4P	4547560 012662

A plug-in conversion is also required to complete the plug-in MCCB

Plug-in Conversion for MCCB



For Removable Part of Plug-in MCCB	Code
3P, 400A	4547560 800047
4P, 400A	4547560 800054

Plug-in conversions for H400 and L400 models are factory fitted. Item numbers for MCCBs complete with plug-in conversions can be found under "400A Frame MCCBs with Plug-in Connections Fitted"
A fixed part is also required to complete the plug-in MCCB

ACCESSORIES FOR 400A & 630A FRAME MCCBS

Extension Terminal for Fixed Part of Plug-in MCCB (PF)



Flat Bar for PIB Field Fit Accessory	Code
3 bars, 400A	4547560 045851
4 bars, 400A	4547560 045868

Control Wiring Terminals for Plug-in MCCBs

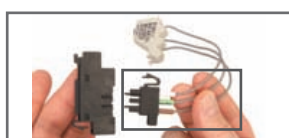

Plug for Removable Part of MCCB, 3 terminals Field Fit Accessory	Code
Plug for auxiliary switches and alarm switches	4547560 800108
Plug for shunt trips and undervoltage trips	4547560 800115

Order one plug for each internal accessory

Control Wiring Terminals for Plug-in MCCBs

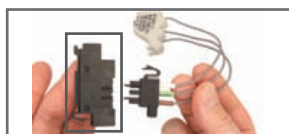

Socket for Fixed Part of MCCB, 3 terminal Field Fit Accessory	Code
Socket	4547560 045004

Order one socket for each internal accessory

Cable Clamps (FW)

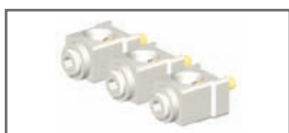

Solderless Terminals Field Fit Accessory	Code
3 clamps, 400A	4547560 014710
4 clamps, 400A	4547560 014727

Cable clamps for H400 and L400 models are factory fitted. Item numbers for MCCBs complete with cable clamps can be found under "400A Frame MCCBs with Cable Clamps Fitted"

Motor Operation (MC)



Field Fit Accessory	Code
100V to 240V AC	4547560 720208
24V DC	4547560 720239
100V to 120V DC	4547560 720253

Motor plus keylock available on request

ORDER CODES

ACCESSORIES FOR 400A & 630A FRAME MCCBS

Motor Operation (MC) with Automatic Reset



Field Fit Accessory	Code
AC 100V to 240V	4547560 720338
DC 24V to 48V	4547560 720345
DC 100V to 120V	4547560 720352

Motor plus keylock available on request

Door Flanges

Field Fit Accessory	Code
For toggle operation	4547560 045400
For motorised operation	4547560 045417

External Operating Handles (Breaker Mounted Type) (HB)



Field Fit Accessory	Code
Black handle IP3X	4547560 724428
Black handle IP3X with keylock	4547560 724404
Red handle IP3X	4547560 725029
Red handle IP3X with keylock	4547560 725005
Black handle IP5X	4547560 724435
Black handle IP5X with keylock	4547560 724411
Red handle IP5X	4547560 725036
Red handle IP5X with keylock	4547560 725012

External Operating Handles (Panel Mounted Type) (HP)



Field Fit Accessory	Code
Black handle IP54	4547560 754197
Black handle IP54 with keylock	4547560 754036
Red handle IP54	4547560 754838
Red handle IP54 with keylock	4547560 754678
Black Handle IP65	4547560 754234
Black Handle IP65 with keylock	4547560 754074
Red Handle IP65	4547560 754876
Red Handle IP65 with keylock	4547560 754715

ACCESSORIES FOR 400A & 630A FRAME MCCBS

Slide Type Mechanical Interlocks (MS)



Field Fit Accessory	Code
E,S type for front, rear connection type 400-630AF 3P	4547560 033704
E,S type for front, rear connection type 400-630AF 4P	4547560 033711
E,S type for plug-in type 400-630AF 3P	4547560 033728
E,S type for plug-in type 400-630AF 4P	4547560 033735
H,L type for front, rear connection type 400-630AF 3P	4547560 033742
H,L type for front, rear connection type 400-630AF 4P	4547560 033759
H,L type for plug-in type 400-630AF 3P	4547560 033766
H,L type for plug-in type 400-630AF 4P	4547560 033773

Order one part between two MCCBs

Link Type Mechanical Interlocks (ML)



Field Fit Accessory	Code
Right side	4547560 035203
Left side 3P	4547560 035210
Left side 4P	4547560 035227

Order one interlock part for each MCCB

Wire Type Mechanical Interlocks (MW)



Field Fit Accessory	Code
Interlock	4547560 036224
1m length interlock cable	4547560 036064
1.5m length interlock cable	4547560 036057

Order one interlock part for each MCCB and one cable between two MCCBs

Handle Locks (HL)



Field Fit Accessory	Code
For 400-630AF	4547560 037207

ORDER CODES

ACCESSORIES FOR 400A & 630A FRAME MCCBS

Castell Lock

Field Fit Accessory	Code
Fittings for panel mounted type handle (lock and key not included)	4547560 037221
Fittings for toggle operated MCCB ((lock and key not included)	4547560 037214

Terminal Covers for Front Connection (CF)



Field Fit Accessory	Code
3P, 1 cover	4547560 080807
4P, 1 cover	4547560 080814
Terminal cover lock	4547560 038006

Terminal Covers for Rear Connection, Cable Clamps and Plug-In (CR)



Field Fit Accessory	Code
3P, 1 cover	4547560 080821
4P, 1 cover	4547560 080838
Terminal cover lock	4547560 038013

Interpole Barriers (BA)

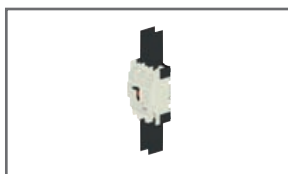

Field Fit Accessory	Code
For E, S, H and L types	4547560 043338

Interpole barriers are supplied as standard: 2 pieces per 3P MCCB, 3 pieces per 4P MCCB.
For additional barriers please order individually

ACCESSORIES FOR 400A & 630A FRAME MCCBS

Lead Terminal Block

Field Fit Accessory	Code
Left side	4547560 044540
Right side	4547560 044557

External Neutral CT

Field Fit Accessory	Code
400A	TBA
630A	215015001

ORDER CODES

TEMBREAK 800A FRAME MCCBS

800A MCCBs with Front Connections



Dimensions		XS	
		XH	TL
h (mm)		273	370
w (mm)	3 pole	210	210
	4 pole	280	280
d (mm)		103	140

Model	I_R (A)		3P	4P
XS800NJ $I_{cu} = 65$ kA Thermal Magnetic	397-630		206520563	206520763
	504-800		206520580	206520780
XS800SE $I_{cu} = 50$ kA <small>Electronic protection codes: A - Standard relay with LSI characteristic ; P - Preferential trip alarm; G - Ground fault; I - Fault indication LEDs</small>	A	318-630	206570563	206570763
	AG	318-630	206575563*	206575763
	AI	318-630	206571563	206571763
	AP	318-630	206572563	206572763
	A	403-800	206570580	206570780
	AG	403-800	206575580*	206575780
	AI	403-800	206571580	206571780
	AP	403-800	206572580	206572780
	A	318-630	206576563	206576763
	AG	318-630	206585563*	206585763
	AI	318-630	206581563	206581763
XH800SE $I_{cu} = 65$ kA <small>Electronic protection codes: A - Standard relay with LSI characteristic ; P - Preferential trip alarm; G - Ground fault; I - Fault indication LEDs</small>	AP	318-630	206582563	206582763
	A	403-800	206576580	206576780
	AG	403-800	206585580*	206585780
	AI	403-800	206581580	206581780
	AP	403-800	206582580	206582780
	252-400		206521540	206521740
	397-630		206521563	206521763
	504-800		206521580	206521780
XH800PJ $I_{cu} = 100$ kA Thermal Magnetic	252-400		206521540	206521740
	397-630		206521563	206521763
	504-800		206521580	206521780

*An external neutral CT must be ordered. See External Accessories.

TEMBREAK 800A FRAME MCCBS

Model		I_R (A)	3P	4P
XH800PE $I_{cu} = 65 \text{ kA}$ Electronic protection codes: A - Standard relay with LSI characteristic ; P - Preferential trip alarm; G - Ground fault; I - Fault indication LEDs	A	318-630	206527563	206527763
	AG	318-630	206525563*	206525763
	AI	318-630	206526563	206526763
	AP	318-630	206528563	206528763
	A	403-800	206527580	206527780
	AG	403-800	206525580*	206525780
	AI	403-800	206526580	206526780
	AP	403-800	206528580	206528780
TL800NE (1600A Frame) $I_{cu} = 125 \text{ kA}$ Electronic protection codes: A - Standard relay with LSI characteristic ; P - Preferential trip alarm; G - Ground fault; I - Fault indication LEDs	A	318-630	206529563	206516563
	AG	318-630	206524563*	206524763
	AI	318-630	206516563	206516763
	AP	318-630	206518563	206518763
	A	403-800	206529580	206529780
	AG	403-800	206524580*	206524780
	AI	403-800	206516580	206516780
	AP	403-800	206518580	206518780

An external neutral CT must be ordered. See External Accessories.

ORDER CODES

INTERNAL ACCESSORIES FOR 800A FRAME TEMBREAK MCCBS (XS800NJ, XS800SE, XH800SE, XH800PJ, XH800PE)

Auxiliary/Alarm Switches

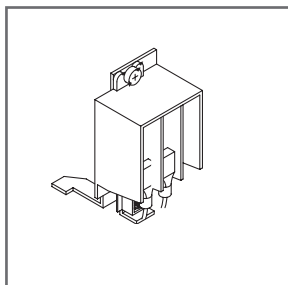

	Code
1 Alarm	215001070
1 Auxiliary	215001005
1 Auxiliary, 1 Alarm	215001042
2 Auxiliaries	215001015
2 Auxiliaries, 1 Alarm	215001052
2 Auxiliaries, 2 Alarms	215001098
3 Auxiliaries	215001025
3 Auxiliaries, 1 Alarm	215001097

Shunt Trips

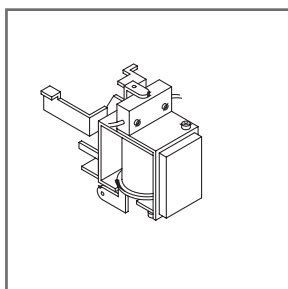

	Code
AC 100-115V	215002006
AC 200-480V	215002014
AC 24V	215002146
AC 48V	215002156
DC 12V	215002024
DC 24V	215002032
DC 48V	215002040
DC 100-115V	215002051
DC 200-230V	215002059
DC 60V	215002164
DC 125V	215002198
DC 30V	215002190

INTERNAL ACCESSORIES FOR 800A FRAME TEMBREAK MCCBS (XS800NJ, XS800SE, XH800SE, XH800PJ, XH800PE)

UnderVoltage Trips

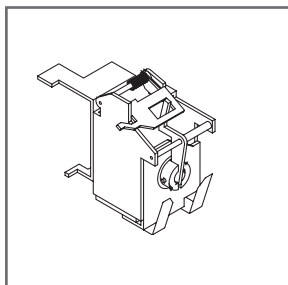

	Code
AC 100-120V	215002067
AC 100-120V TIME DELAY	215002119
AC 100-120V 1SEC TIME DEL	215002243
AC 100-120V 2SEC TIME DEL	215002253
AC 200-240V	215002075
AC 200-240V TIME DELAY	215002127
AC 200-240V 1SEC TIME DEL	215002206
AC 200-240V 2SEC TIME DEL	215002215
(IND) 240V	215002313
AC 380-450V	215002083
AC 380-450V TIME DELAY	215002135
AC 380-450V 1SEC TIME DEL	215002226
AC 380-450V 2SEC TIME DEL	215002235
DC 100-115V	215002101
DC 200-230V	215002111
DC 24V	215002093
DC 48V	215002173
DC 60V	215002181

ORDER CODES

EXTERNAL ACCESSORIES FOR 800A FRAME TEMBREAK MCCBS

Connections

		Code
3 Pole	3 extension Bars (630A)	215003357
	3 extension Bars (800A)	215003359
	Drawout conversion kit (630A)*	215003243
	Drawout conversion kit (800A)*	215003251
	3 cable Clamps	215003192
	Plug in conversion kit (630A)**	215003141
	Plug in conversion kit (800A)**	215003143
	3 rear connection studs (top)	215003115
	3 rear connection studs (bottom)	215003103
	Auxiliary connector plug for plug in and drawout**	215003072

		Code
4 Pole	4 extension Bars (630A)	215003358
	4 extension Bars (800A)	215003360
	Drawout conversion kit (630A)*	215003247
	Drawout conversion kit (800A)*	215003256
	4 cable clamps	215003193
	4 rear connection studs (top)	215003116
	4 rear connection studs (bottom)	215003104
	Plug in conversion kit (630A)**	215003142
	Plug in conversion kit (800A)**	215003144
	Auxiliary connector plug for plug in and drawout**	215003072

*Drawout chassis and auxiliary connectors must be ordered separately

** Plug in base and auxiliary connectors must be ordered separately

*** Auxiliary connector socket must be ordered separately

EXTERNAL ACCESSORIES FOR 800A FRAME TEMBREAK MCCBS

Motor Operators

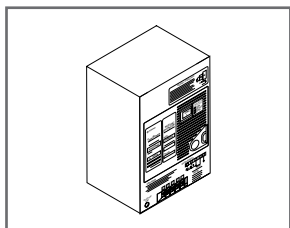

		Code
AC 100-110V		215008016
AC 200~220V		215008024
AC 240V		215008043
DC 24V		215008054
DC 110V		215008057

Terminal Covers

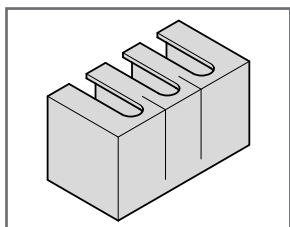

		Code
3 Pole	2 covers for front connection	215004018
	2 interpole barriers	215004042
	2 covers for rear connection and plug in	215004024

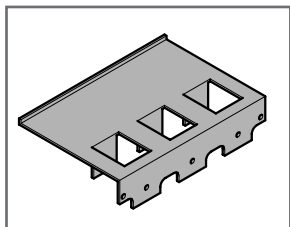

		Code
4 Pole	2 covers for front connection	215004019
	2 interpole barriers	215004043
	2 covers for rear connection and plug in	215004025

Drawout Chassis

		Code
3P	Drawout Chassis 630A	215014021
4P	Drawout Chassis 630A	215014028
3P	Drawout Chassis 800A	215014036
4P	Drawout Chassis 800A	215014045

ORDER CODES

EXTERNAL ACCESSORIES FOR 800A FRAME TEMBREAK MCCBS

External Operating Handles

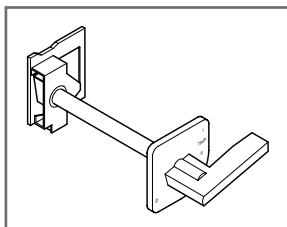

	Code
Door Mounted Black handle IP54 (TemBreak 2)	TBA
Door Mounted Black handle IP65 (TemBreak 2)	TBA
Door Mounted Red handle IP54 (TemBreak 2)	TBA
Door Mounted Red handle IP65 (TemBreak 2)	TBA
IP65 Gasket Kit (TemBreak 2)	TBA
Door Mounted Handle (TemBreak)	215005035
LEFT:BLACK Breaker mounted HANDLE	215005227
LEFT:BLACK Breaker mounted :IP55 HANDLE	215005235
LEFT:RED/YEL Breaker mounted HANDLE	215005243
LEFT:RED/YEL Breaker mounted: IP55 HANDLE	215005251
RIGHT:BLACK Breaker mounted HANDLE	215005195
RIGHT:BLACK Breaker mounted: IP55 HANDLE	215005203
RIGHT:RED/YEL Breaker mounted HANDLE	215005211
RIGHT:RED/YEL Breaker mounted :IP55 HANDLE	215005219
UPPER:BLACK Breaker mounted HANDLE	215005259
UPPER:BLACK Breaker mounted :IP55 HANDLE	215005267
UPPER:RED/YEL Breaker mounted HANDLE	215005275
UPPER:RED/YEL Breaker mounted:IP55 HANDLE	215005283
OHE:Handle Mechanism	215005156
Door Flange	215005160

LEFT, RIGHT and UPPER refer to the direction of incoming power supply

Plug-in Bases

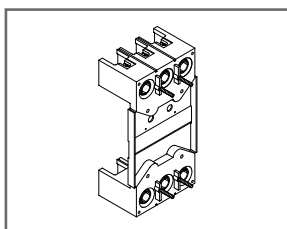

		Code
3 Pole	Plug In Base	215007039
	Plug In Base with extension bars	215007011
	IP20 Plug in base	215007069
	IP20 Plug in base with extension bars	215007021
	Auxiliary connector socket for plug in	215007049

EXTERNAL ACCESSORIES FOR 800A FRAME TEMBREAK MCCBS

Plug-in Bases

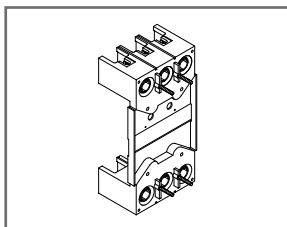

		Code
4 Pole	Plug In Base	215007040
	Plug In Base with extension bars	215007136
	IP20 Plug in base	215007070
	IP20 Plug in base with extension bars	215007140
	Auxiliary connector socket for plug in	215007049

Accessory Terminal Blocks

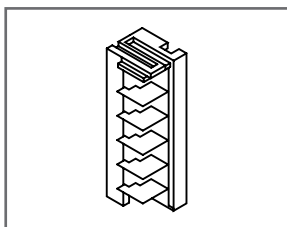

		Code
1 Off	Accessory Terminal Block	215006001
2 Off	Accessory Terminal Block	215006002
3 Off	Accessory Terminal Block	215006003
4 Off	Accessory Terminal Block	215006004

Mechanical Interlocks

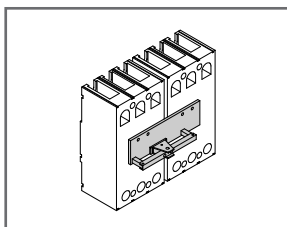

Factory-fitted except front mechanical interlock		Code
3 Pole	Front Mechanical Interlock	215009005
	Rear Mechanical Interlock	215009023
	1m Wire Mechanical Interlock	215009035
	1.5m wire mechanical interlock	215009040
	Rear Mech Interlock+accessory terminals*	215009060
	Rear Mech Interlock+TemTransfer terminal†	215009138
	Rear Mechanical Interlock for Plug in+accessory terminals*	215009080

*Includes backplate and mounting frame

†Refer to page 235 for TemTransfer order codes

Factory-fitted except front mechanical interlock		Code
4 Pole	Front Mechanical Interlock	215009006
	Rear Mechanical Interlock	215009024
	1m Wire Mechanical Interlock	215009035
	1.5m wire mechanical interlock	215009040
	Rear Mech Interlock+accessory terminals*	215009061
	Rear Mech Interlock+TemTransfer terminals†	215009139
	Rear Mechanical Interlock for Plug in+accessory terminals*	215009045

*Includes backplate and mounting frame

†Refer to page 235 for TemTransfer order codes

ORDER CODES

EXTERNAL ACCESSORIES FOR 800A FRAME TEMBREAK MCCBS

Castell Locks

	Code
Castell A Lock in Closed	215010010
Castell B Lock in Closed	215010024
Castell Special Lock in Closed	215010047
Castell A Lock in Open	215010058
Castell B Lock in Open	215010069
Castell Special Lock in Open	215010094
Castell Lock XFH Handle	215010100
Cam for XFH Handle	215010102
Castell Lock XFH SP Handle	215010107

Handle Locks

	Code
Handle Lock	215011004
Handle Extension	215011007
Adjustment Seal Facility	215011014

External Neutral CTs

	Code
630A	215015001
800A	215015002

TEMBREAK 1250A & 1600A FRAME MCCBS

1250A MCCBs with Extension Bars



Dimensions		XS	TL
h (mm)		370	370
w (mm)	3 pole	210	210
	4 pole	280	280
d (mm)		120	140

Model	I_R (A)		3P	4P
XS1250CE $I_{cu} = 50 \text{ kA}$ Electronic protection codes: A - Standard relay with LSI characteristic ; P - Preferential trip alarm; G - Ground fault; I - Fault indication LEDs	A	504-1000	206660510	206660710
	AG	504-1000	206665510*	206665710
	AI	504-1000	206661510	206661710
	AP	504-1000	206662510	206662710
	A	630-1250	206660512	206660712
	AG	630-1250	206665512*	206665712
	AI	630-1250	206661512	206661712
	AP	630-1250	206662512	206662712
XS1250SE $I_{cu} = 85 \text{ kA}$ Electronic protection codes: A - Standard relay with LSI characteristic ; P - Preferential trip alarm; G - Ground fault; I - Fault indication LEDs	A	504-1000	206670510	206670710
	AG	504-1000	206675510*	206675710
	AI	504-1000	206671510	206671710
	AP	504-1000	206672510	206672710
	A	630-1250	206670512	206670712
	AG	630-1250	206675512*	206675712
	AI	630-1250	206671512	206671712
	AP	630-1250	206672512	206672712
TL1250NE (1600A Frame) $I_{cu} = 125 \text{ kA}$ Electronic protection codes: A - Standard relay with LSI characteristic ; P - Preferential trip alarm; G - Ground fault; I - Fault indication LEDs	A	504-1000	206629510	206629710
	AG	504-1000	206625510*	206625710
	AI	504-1000	206626510	206626710
	AP	504-1000	206628510	206628710
	A	630-1250	206629512	206629712
	AG	630-1250	206625512*	206625712
	AI	630-1250	206626512	206626712
	AP	630-1250	206628512	206628712

An external neutral CT must be ordered. See External Accessories.

ORDER CODES

TEMBREAK 1250A & 1600A FRAME MCCBS

1600A MCCBs with Various Terminal Types



Dimensions		
h (mm)		370
w (mm)	3 pole	210
	4 pole	280
d (mm)		120

Model	I_R (A)		3P	4P
XS1600CE $I_{cu} = 50$ kA <i>Electronic protection codes:</i> A - Standard relay with LSI characteristic ; P - Preferential trip alarm; G - Ground fault; I - Fault indication LEDs	A	806-1600 FC	206760516	206760716
	AG	806-1600 FC	206765516*	206765716
	AI	806-1600 FC	206761516	206761716
	AP	806-1600 FC	206762516	206762716
	A	806-1600 RC	206760616	206760816
	AG	806-1600 RC	206765616*	206765816
	AI	806-1600 RC	206761616	206761816
	AP	806-1600 RC	206762616	206762816
	A	806-1600 DO	206760916	206760016
	AG	806-1600 DO	206765916*	206765016
	AI	806-1600 DO	206761916	206761016
	AP	806-1600 DO	206762916	206762016
	A	806-1600 FC	206770516	206770716
	AG	806-1600 FC	206775516*	206775716
	AI	806-1600 FC	206771516	206771716
XS1600SE $I_{cu} = 100$ kA <i>Electronic protection codes:</i> A - Standard relay with LSI characteristic ; P - Preferential trip alarm; G - Ground fault; I - Fault indication LEDs	AP	806-1600 FC	206772516	206772716
	A	806-1600 RC	206770616	206770816
	AG	806-1600 RC	206775616*	206775816
	AI	806-1600 RC	206771616	206771816
	AP	806-1600 RC	206772616	206772816
	A	806-1600 DO	206770916	206770016
	AG	806-1600 DO	206775916*	206775016
	AI	806-1600 DO	206771916	206771016
	AP	806-1600 DO	206772916	206772016

Key to MCCB connection codes:

FC - with front connections; RC - with rear connections;

DO - with drawout connections

* An external Neutral CT must be ordered. See External Accessories.

INTERNAL ACCESSORIES FOR 1250A & 1600A FRAME

TEMBREAK MCCBS (TL800NE, XS1250CE, XS1250SE, TL1250NE, XS1600CE, XS1600SE)

Auxiliary/Alarm Switches

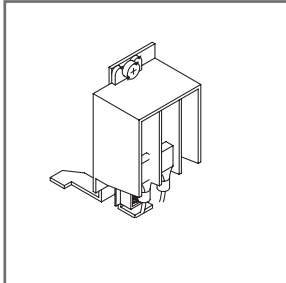

		Code
3 Pole	1 Alarm	212001071
	1 Auxiliary	212001006
	1 Auxiliary, 1 Alarm	212001043
	2 Auxiliaries	212001016
	2 Auxiliaries, 1 Alarm	212001053
	2 Auxiliaries, 2 Alarms	212001102
	3 Auxiliaries	212001026
	3 Auxiliaries, 1 Alarm	212001101

		Code
4 Pole	1 Alarm	212001072
	1 Auxiliary	211001007
	1 Auxiliary, 1 Alarm	212001044
	2 Auxiliaries	212001017
	2 Auxiliaries, 1 Alarm	212001054
	2 Auxiliaries, 2 Alarms	212001104
	3 Auxiliaries	212001027
	3 Auxiliaries, 1 Alarm	212001103

Shunt Trips

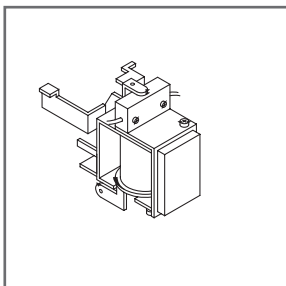

	Code
AC 100-115V	212002007
AC 200-480V	212002015
AC 24V	211002147
AC 48V	211002157
DC 100-115V	212002052
DC 12V	211002025
DC 125V	212002199
DC 200-230V	212002060
DC 24V	212002033
DC 30V	212002191
DC 48V	212002041
DC 60V	211002165

ORDER CODES

INTERNAL ACCESSORIES FOR 1250A & 1600A FRAME TEMBREAK MCCBS

UnderVoltage Trips

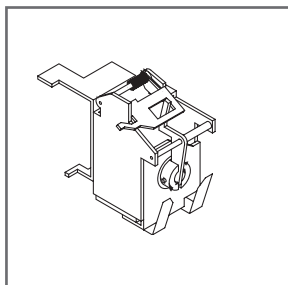

Field Fit Accessory	Code
AC 100-120V	212002068
AC 100-120V Time Delay	212002120
AC 100-120V 1Sec Time Delay	211002244
AC 100-120V 2Sec Time Delay	211002254
AC 200-240V	212002076
AC 200-240V Time Delay	212002128
AC 200-240V 1Sec Time Delay	212002208
AC 200-240V 2Sec Time Delay	211002216
(IND) 240V	211002314
AC 380-450V	211002084
AC 380-450V Time Delay	212002136
AC 380-450V 1Sec Time Delay	211002228
AC 380-450V 2Sec Time Delay	211002236
DC 100-115V	212002102
DC 200-230V	212002112
DC 24V	212002094
DC 48V	212002174
DC 60V	212002183

EXTERNAL ACCESSORIES FOR 1250A & 1600A FRAME TEMBREAK MCCBS

Connections

1250A		Code
3 Pole	6 rear connection bars	212003025
	3 rear connection bars (bottom)	211003099
	3 rear connection bars (top)	211003110
	IP20 Plug In Conversion kit*	212003145
	Drawout Conversion kit**	212003260
	Auxiliary connector plug for plug in and drawout***	215003072

1250A		Code
4 Pole	8 rear connection studs	212003026
	4 rear connection bars (bottom)	212003100
	4 rear connection bars (top)	212003111
	IP20 Plug In Conversion kit*	212003146
	Drawout Conversion kit**	212003264
	Auxiliary connector plug for plug in and drawout***	215003072

1600A		Code
3 Pole	3 rear connection bars (bottom)	212003212
	3 rear connection bars (top)	212003112

1600A		Code
4 Pole	4 rear connection bars (bottom)	211003309
	4 rear connection bars (top)	211003308

*Drawout chassis and auxiliary connectors must be ordered separately

** Plug in base and auxiliary connectors must be ordered separately

*** Auxiliary connector socket must be ordered separately

ORDER CODES

EXTERNAL ACCESSORIES FOR 1250A & 1600A FRAME TEMBREAK MCCBS

Motor Operators

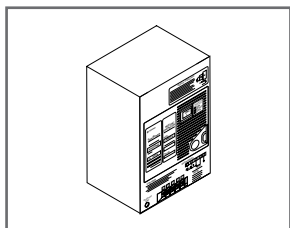

		Code
AC100-115V		211008074
AC200-230V		211008075
DC 24V		211008076
DC100-110V		211008077
AC 240V		212008044

Terminal Covers

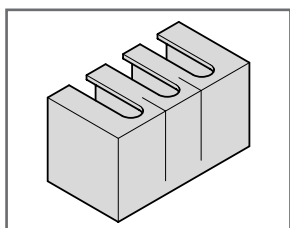

1250A		Code
3 Pole	2 covers for front connection	211004020
	1 cover for front connection	211004070

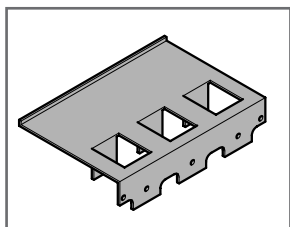

1250A		Code
4 Pole	2 covers for front connection	211004021
	1 cover for front connection	211004071

Drawout Chassis

1250A		Code
3 Pole	Drawout Chassis	211014053
4 Pole	Drawout Chassis	211014061

EXTERNAL ACCESSORIES FOR 1250A & 1600A FRAME TEMBREAK MCCBS

Handles

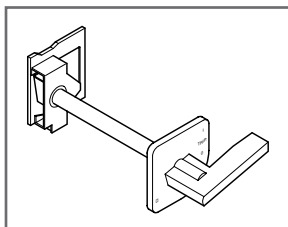

	Code
Door Mounted Black handle IP54 (TemBreak 2)	TBA
Door Mounted Black handle IP65 (TemBreak 2)	TBA
Door Mounted Red handle IP54 (TemBreak 2)	TBA
Door Mounted Red handle IP65 (TemBreak 2)	TBA
IP65 Gasket Kit (TemBreak 2)	TBA
Door Mounted Handle	212005036
Left:Black Breaker mounted Handle	211005228
Left:Black Breaker mounted:IP55 Handle	211005236
Left:Red/Yellow Breaker mounted Handle	211005244
Left:Red/Yellow Breaker mounted:IP55 Handle	211005252
Right:Black Breaker mounted Handle	211005196
Right:Black Breaker mounted :IP55 Handle	211005204
Right:Red/Yellow Breaker mounted Handle	211005212
Right:R/Y Breaker mounted:IP55 Handle	211005220
Upper:Black Breaker mounted Handle	211005260
Upper:Black Breaker mounted:IP55 Handle	211005268
Upper:Red/Yellow Breaker mounted Handle	211005276
Upper:R/Y Breaker mounted:IP55 Handle	211005284
OHE:Handle Mechanism	211005157
Door Flange	211005161

Plug-in Bases

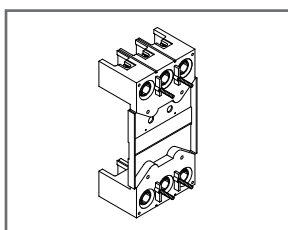

1250A		Code
3 Pole	Plug In Base	211007041
	IP20 Plug In Base	211007071
	Auxiliary connector socket for plug in base	215007049

1250A		Code
4 Pole	Plug In Base	211007042
	IP20 Plug In Base	211007072
	Auxiliary connector socket for plug in base	215007049

ORDER CODES

EXTERNAL ACCESSORIES FOR 1250A & 1600A FRAME TEMBREAK MCCBS

Accessory Terminal Blocks

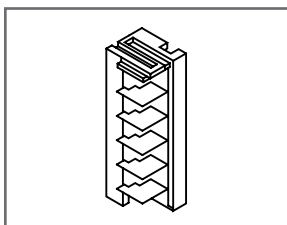

	Code
1 Off Accessory Terminal Block	215006001
2 Off Accessory Terminal Block	215006002
3 Off Accessory Terminal Block	215006003
4 Off Accessory Terminal Block	215006004

Mechanical Interlocks

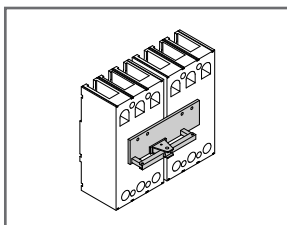

1250A Factory-fitted except front mechanical interlock		Code
3 Pole	Front Mechanical Interlock	211009007
	Rear Mechanical Interlock	211009025
	Rear Mechanical Interlock + Accessory terminals*	211009028
	Rear Mechanical Interlock + TemTransfer terminals†	211009140
	1M Wire mechanical interlock	211009036
	1.5M Wire mechanical interlock	211009041
	Rear mechanical interlock for plug in + accessory terminals*	211009081

*Includes backplate and mounting frame

†Refer to page 235 for TemTransfer order codes

1250A Factory-fitted except front mechanical interlock		Code
4 Pole	Front Mechanical Interlock	211009008
	Rear Mechanical Interlock	211009026
	Rear Mechanical Interlock + Accessory terminals*	211009029
	Rear Mechanical Interlock + TemTransfer terminals†	211009141
	1M Wire mechanical interlock	211009036
	1.5M Wire mechanical interlock	211009041
	Rear mechanical interlock for plug in + accessory terminals*	211009082

*Includes backplate and mounting frame

†Refer to page 235 for TemTransfer order codes

EXTERNAL ACCESSORIES FOR 1250A & 1600A FRAME TEMBREAK MCCBS

Mechanical Interlocks

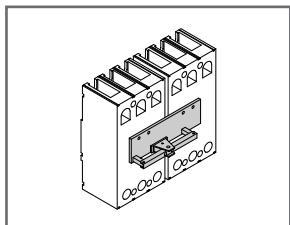

1600A Factory-fitted except front mechanical interlock		Code
3 Pole	Front Mechanical Interlock	211009007
	Rear Mechanical Interlock	211009027
	Rear Mechanical Interlock + Accessory terminals	211009030
	Rear Mechanical Interlock + TemTransfer terminals	211009142
	1M Wire mechanical interlock	211009037
	1.5M Wire mechanical interlock	211009042

1600A Factory-fitted except front mechanical interlock		Code
4 Pole	Front Mechanical Interlock	211009008
	Rear Mechanical Interlock	211009087
	Rear Mechanical Interlock + Accessory terminals	211009055
	Rear Mechanical Interlock + TemTransfer terminals	211009143
	1M Wire mechanical interlock	211009037
	1.5M Wire mechanical interlock	211009042

Castell Locks

	Code
Castell A Lock In Close	211010013
Castell B Lock In Close	211010025
Castell A Lock In Open	211010059
Castell B Lock In Open	211010070
Castell Lock XFH Handle	215010100
CAM FOR XFH Handle	215010102
Castell Lock XFH SP Handle	215010107
Castell SPEC Lock In Close	211010048
Castell SPEC Lock In Open	211010097

ORDER CODES

EXTERNAL ACCESSORIES FOR 1250A & 1600A FRAME TEMBREAK MCCBS

Handle Locks

	Code
Handle Lock	211011005
Handle Extension	215011007
Adjustment Seal Facility	211011015

External Neutral CTs

	Code
1000A	211015003
1250A	211015004
1600A	211015005

TEMBREAK 2 MINI MCCBS

Mini MCCBs with Front Connections



Dimensions		
h (mm)		100
w (mm)	2 pole	50
	3 pole	75
d (mm)		60

Model	I _n (A)	2P	3P
S50-NF I _{cu} =10 kA Thermal Magnetic	10	4547560 203008	4547560 203107
	15	4547560 203015	4547560 203114
	20	4547560 203022	4547560 203121
	30	4547560 203039	4547560 203138
	40	4547560 203046	4547560 203145
	50	4547560 203053	4547560 203152
E100-NF I _{cu} =10 kA Thermal Magnetic	50	4547560 251207	4547560 251306
	60	4547560 251214	4547560 251313
	75	4547560 251221	4547560 251320
	100	4547560 251238	4547560 251337

ORDER CODES

ACCESSORIES FOR TEMBREAK 2 MINI MCCBS

Auxiliary Switches (AX)



Field Fit Accessory	Code
Left Pole	4547560 705007
Right Pole	4547560 705014
Low current (mA), left pole	4547560 705038
Low current (mA), right pole	4547560 705045
Left Pole with terminal block	4547560 705205
Right Pole with terminal block	4547560 705212
Low current (mA), left pole with terminal block	4547560 705236
Low current (mA), right pole with terminal block	4547560 705243

Combined Auxiliary and Alarm Switches



Field Fit Accessory	Code
Left Pole	4547560 705106
Right Pole	4547560 705120
Low current (mA), left pole	4547560 705113
Low current (mA), right pole	4547560 705137
Left Pole with terminal block	4547560 705304
Right Pole with terminal block	4547560 705328
Low current (mA), left pole with terminal block	4547560 705311
Low current (mA), right pole with terminal block	4547560 705335

Alarm Switches (AL)



Field Fit Accessory	Code
Left Pole	4547560 705403
Right Pole	4547560 705410
Low current (mA), left pole	4547560 705434
Low current (mA), right pole	4547560 705441
Left Pole with terminal block	4547560 705502
Right Pole with terminal block	4547560 705519
Low current (mA), left pole with terminal block	4547560 705533
Low current (mA), right pole with terminal block	4547560 705540

ACCESSORIES FOR TEMBREAK 2 MINI MCCBS

Shunt Trips (SHT)



Field Fit Accessory	Code
AC 100-120V	4547560 705601
AC 200-240V	4547560 705618
AC 380-450V	4547560 705625
AC 100-120V with Terminal Block	4547560 705700
AC 200-240V with Terminal Block	4547560 705717
AC 380-450V with Terminal Block	4547560 705724

Extension Bars *Flat Bars* (FB)

Field Fit Accessory	3 Pole only	Code
both sides for 50AF		4547560 706516
both sides for 100AF		4547560 706530

Rear Connections *Flat Bar Studs* (RP)

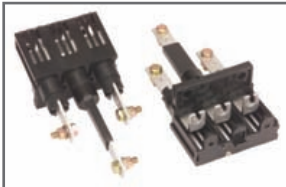

Field Fit Accessory	3 Pole only	Code
for 50AF (vertical-horizon)		4547560 706615
for 50AF (horizon-vertical)		4547560 706776
for 50AF (vertical-vertical)		4547560 706660
for 50AF (horizon-horizon)		4547560 706677
for 100AF (vertical-horizon)		4547560 706639
for 100AF (horizon-vertical)		4547560 706790
for 100AF (vertical-vertical)		4547560 706745
for 100AF (horizon-horizon)		4547560 706752

Mechanical Interlock, Slide Type (MS)

Field Fit Accessory	Code
Breaker mounted type for 50 to 100AF,3P,FC	4547560 707919

ORDER CODES

ACCESSORIES FOR TEMBREAK 2 MINI MCCBS

TB2 Mini MCCB Accessories

Handle Lock (HL)

Field Fit Accessory	Code
for 50AF and 100AF	4547560 708909

Terminal Cover

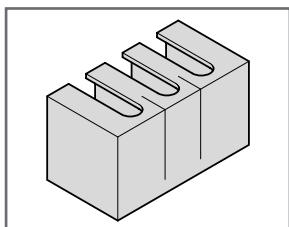

Field Fit Accessory	3 Pole only	Code
short type		4547560 708305
long type		4547560 708503
earth barrier		4547560 708619

Interpole Barrier

Field Fit Accessory	Code
	4547560 708817

Earth Barrier

Field Fit Accessory	Code
For 50Af and 100AF, 2P	4547560 708602
For 50AF and 100AF, 3P	4547560 708619

SWITCH-DISCONNECTORS ALL FRAME SIZES

Model	I_e (A)	I_{cm} (kA)	3P	4P
E50-NN	50	1.5	4547560 203305	--
E100-NN	100	1.7	4547560 251504	--
S125-NN	125	3.6	4547560 244902	4547560 245008
S160-NN	160	6	4547560 315800	4547560 315909
S250-NN	250	6	4547560 316005	4547560 316104
S400-NN	400	9	4547560 371608	4547560 371707
S630-NN	630	9	4547560 364204	4547560 364303

Model	I_n	I_{cm}	3P	4P
XS800NN	800	15	206590580	206590780
XS1250NN	1250	32	206690512	206690712
XS1600NN FC	1600	45	206790516	206790716
XS1600NN RC	1600	45	206790616	206790816
XS1600NN DO	1600	45	206790916	206790016

ORDER CODES

TEMTRANSFER

TemTransfer Automatic Changeover Controller



302001000	TemTransfer 115V
302001001	TemTransfer (230V)
302001002	TemTransfer Interface Kit
215009159	TemTransfer wiring kit/FC/630/800
211009160	TemTransfer wiring kit/FC/1250/1600

