

Industrial multipole connectors

revos IT

Technical Data

■ Approvals

IEC 61 984

■ Hoods and housings

Material

Die-cast aluminium

Surface finish

Silver grey, silicon-free finish, powder coated

Clamping screws

Zinc plated steel

Locking levers

Steel galvanically zinc plated and dichromated

Gaskets

Neoprene (oil resistant and anti-aging)

2 Cable feed throughs

Cable diameter 2 to 10 mm

1 Cable feed through

Cable diameter 9 to 15 mm

Temperature range

–40 to +100 °C

Degree of protection according to

DIN EN 60 529

With latched locking levers

IP 55

With appropriate cable glands

IP 65

Industrial multipole connectors

Data cable entry

revos IT

The data cable entry hood is designed to divide into two half shells. Each is fitted with an O-ring seal, and joined by two threaded screws. Each half shell has a special rubber clamping profile which ensures that the cable is perfectly sealed. Three metal clamps provide a strain relief.

The **Data cable entry** hood provides a secure strain relief facility for feeding cables into open housings without having to disassemble the connecting plug. It is the ideal solution for connecting cables from programmable controllers, data lines, measuring and sensor lines.

Each data cable entry hood has three glands to take cable of various diameters. Entries which are not used are sealed off by plastic covers.

The data cable entry hood can be snapped onto the 16 pole housing. In normal conditions, these housings provide enough room to feed through plug and data or measuring lines without any problems.

Technical Data

Hoods and housings

Die cast aluminium alloy with silver grey silicon-free finish and powder coated

Temperature range: -40°C to $+100^{\circ}\text{C}$

Clamping screws: zinc-plated steel

Locking levers: steel
zinc plated and chromated

Gaskets: Neoprene
(oil resistant and anti-aging)

They meet the degree of protection IP 65 according to EN 60 529 (IEC 60 529)

2 cable feed through for cable diameters 2 mm – 10 mm

1 cable feed through for cable diameters 9 mm – 15 mm



revos



Type	Part No.	Box Qty
Data cable feed through	70.060.1628.0	10
16 pole housing	70.320.1628.0	1
Rubber gaskets can be ordered as replacement parts		
Rubber gasket for:		
Connection range 2 mm – 10 mm	05.562.3183.0	10
Connection range 9 mm – 15 mm	05.562.3283.0	10

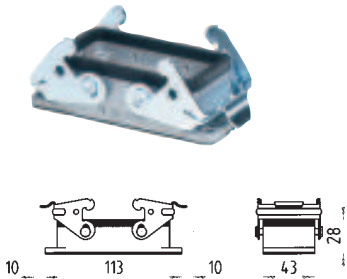

Mounting dimensions and cut out for open housing

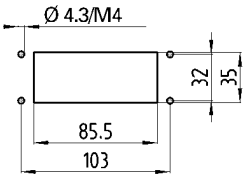

Industrial multipole connector with single locking levers, D-sub connectors

revos IT



D-Sub connectors

IP 55 Protection
IP 65 Protection with suitable cable glands

Pole configuration	Part No.	Part No.	Box Qty	Hood size
	 <p>Housing with socket connector</p>	 <p>Hood with plug connector</p>		
9 pole	Z7.415.0010.0	Z7.415.0235.0	10	6
2 x 9 = 18 pole	Z7.415.0110.0	Z7.415.0335.0	10	6
15 pole	Z7.415.0810.0	Z7.415.1035.0	10	6
2 x 15 = 30 pole	Z7.415.0910.0	Z7.415.1135.0	10	6
25 pole	Z7.415.1610.0	Z7.415.1935.0	10	10
15 + 25 = 40 pole	Z7.415.1810.0	Z7.415.2135.0	10	10
2 x 25 = 50 pole	Z7.415.1710.0	Z7.415.2035.0	10	10
37 pole	Z7.415.2410.0	Z7.415.2635.0	10	16
2 x 37 = 74 pole	Z7.415.2510.0	Z7.415.2735.0	10	16
50 pole	Z7.415.3210.0	Z7.415.3335.0	10	16
2 x 50 = 100 pole	Z7.415.3410.0	Z7.415.3535.0	10	16

revos

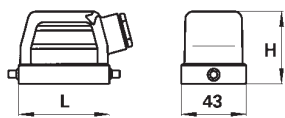

Size	L	H
6	60	47.5
10	73	53
16	93.5	60

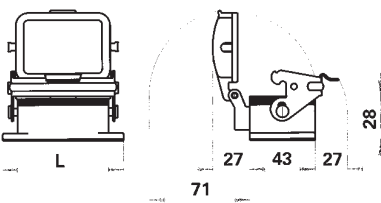

Size	L
6	80
10	93
16	113

Delivery status

Hoods and housings, D-Sub connectors, mounting screws and mounting plates are delivered unassembled.

Hood with M20 cable gland.

The contacts are nickle plated and hard gold plated in the contact area.

Current carrying capacity per contact
with ambient temperatures of:

+ 20 °C	5 A
+ 70 °C	3 A
+ 100 °C	1.5 A

Solder connection
max. 0.5 mm²

Rated voltage
40 V/1 kV/2

Mounting dimensions and cut outs
for open housings

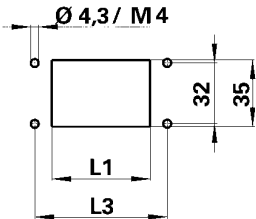

Size	L1	L3
6	52	70
10	65	83
16	85.5	103